

16910 NE 131st Pl, Redmond

| \$1,325,000

ROSEWOOD NEIGHBORHOOD



Complete details, photos, 3D tour, 4K video tour and Pre-Inspection at:

EnglishHillHome.com







Beautiful Two Story Home in Rosewood on English Hill

The light-filled 2,390 s.f. floorplan features 4 bedrooms, 2.25 baths plus Bonus Room on a well manicured 9,755 s.f. lot. Special features include: Newly refinished and expanded oak flooring throughout main level, new carpet, fresh paint, dual pane vinyl Low-E windows, updated kitchen and baths, huge bonus room, recent roof replacement and large lot with level back yard.

Inviting, light-filled entry with beautiful hardwood floors. Bright and open formal living room with large bay window, gas fireplace, and ample space for entertainment or relaxation. Connected formal dining room off kitchen with gorgeous decorative lighting and large windows overlooking the rear yard. Updated kitchen with Corian counters, maple cabinetry, stainless steel appliances and breakfast bar peninsula. Family room off kitchen with ample natural light, gas fireplace, and large slider leading to back deck and patio. Updated guest bathroom on main floor includes stylish vanity and decorative wainscoting.

Gorgeous primary suite with vaulted ceiling, spacious primary bath and large walk-in closet. Large primary bath features new luxury vinyl tile flooring, new double vanity with quartz counter, and tile wrapped walk-in shower with new fixtures and modern glass shower door. Three additional spacious bedrooms upstairs filled with natural light. Huge bonus room on the upper level includes new heater units with programmable thermostat, and offers flexible space to relax, entertain, or play! Adjacent hall bathroom with new luxury vinyl tile flooring, decorative wainscoting, and white shower over tub.

Fully fenced, private yard on huge lot with lush plantings, large entertainment sized deck, and convenient storage shed. Attached two car garage with work bench included.

Northshore schools - Sunrise Elementary, Timbercrest Middle School & Woodinville High.



VIEW PROPERTY DETAILS ON YOUR PHONE

Type Website or Scan the QR Code to gain instant access



Property Details | Property Disclosures | Pre-Inspection Report
Additional Photos | 3D Walkthrough | Video Tour

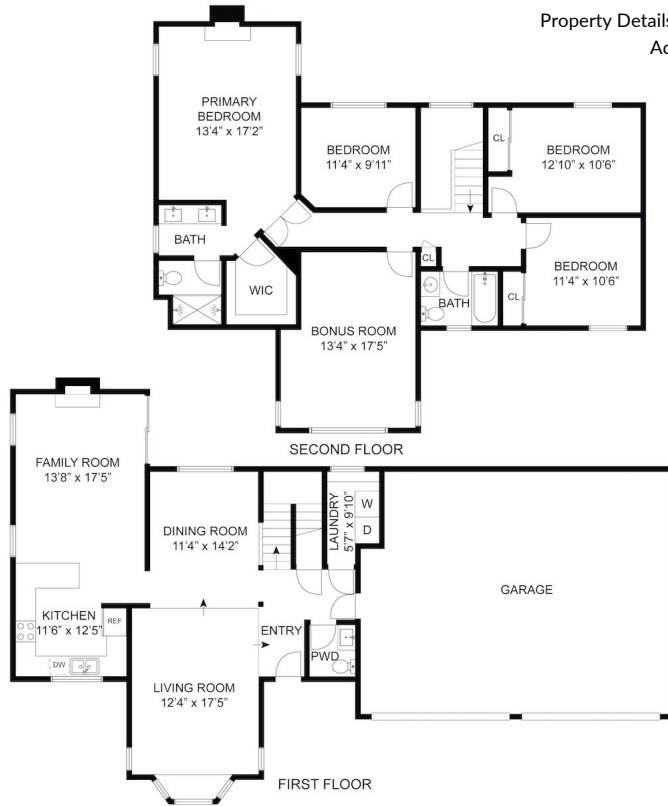

SIZES AND DIMENSIONS ARE APPROXIMATE, ACTUAL MAY VARY.

Home Features

Bedrooms 4 | Baths 2.25 | 2,390 Square Feet | 9,755 Sq. Ft. Lot | Huge Bonus Room!

Style	Two Story
Bedrooms	1 Primary Bedroom, 3 Additional Bedrooms
Baths	1 Full Bath, 3/4 Bath, 1/2 Guest Bath
Flooring	Hardwood, Engineered Hardwood, Luxury Vinyl Tile, Carpet.
Entry	Inviting, light-filled entry with beautiful hardwood floors.
Living Room	Bright and open formal living room with large bay window, gas fireplace, and ample space for entertainment or relaxation.
Dining Room	Formal dining room off kitchen with gorgeous decorative lighting and large windows overlooking the rear yard.
Kitchen	Updated kitchen with Corian counters, maple cabinetry, stainless steel appliances and breakfast bar peninsula.
Family Room	Family room off kitchen with ample natural light, gas fireplace, and large slider leading to back deck and patio.
Powder Room	Updated guest bathroom on main floor with decorative wainscoting and new vanity.
Primary Bedroom	Gorgeous primary suite with vaulted ceiling, spacious primary bath and large walk-in closet.
Primary Bathroom	Large primary bath features new luxury vinyl tile flooring, new double vanity with quartz counter, and tile wrapped walk-in shower with new fixtures and modern glass door.

Bonus Room	Huge bonus room on the upper level includes new heater units with programmable thermostat, and offers a flexible space to relax, entertain, or play!
Bedrooms	Three additional spacious bedrooms upstairs filled with natural light.
Laundry	Laundry room on lower level near garage, washer and dryer included!
Hall Bath	Adjacent hall bathroom with new luxury vinyl tile flooring, decorative wainscoting, and white shower over tub.
Yard	Fully fenced, private yard on a huge lot with lush plantings, large entertainment sized deck, and convenient storage shed.
Garage	Attached two car garage with work bench included.
Heating	Forced Air, Natural Gas.
Roof	CertainTeed Landmark asphalt shingle roof installed November 2020.
Year Built	1984
Utilities	Water: Woodinville Water District Sewer: Woodinville Water District Electricity: Puget Sound Energy Gas: Puget Sound Energy Internet: Xfinity / Ziplly
School District	Northshore High School: Woodinville Middle School: Timbercrest Elementary : Sunrise