

SKETCH ADDENDUM

Borrower/Client John Paddleford
 Property Address 17249 NE 125th St
 City Redmond County King State WA Zip Code 98052
 Lender Caliber Home Loans

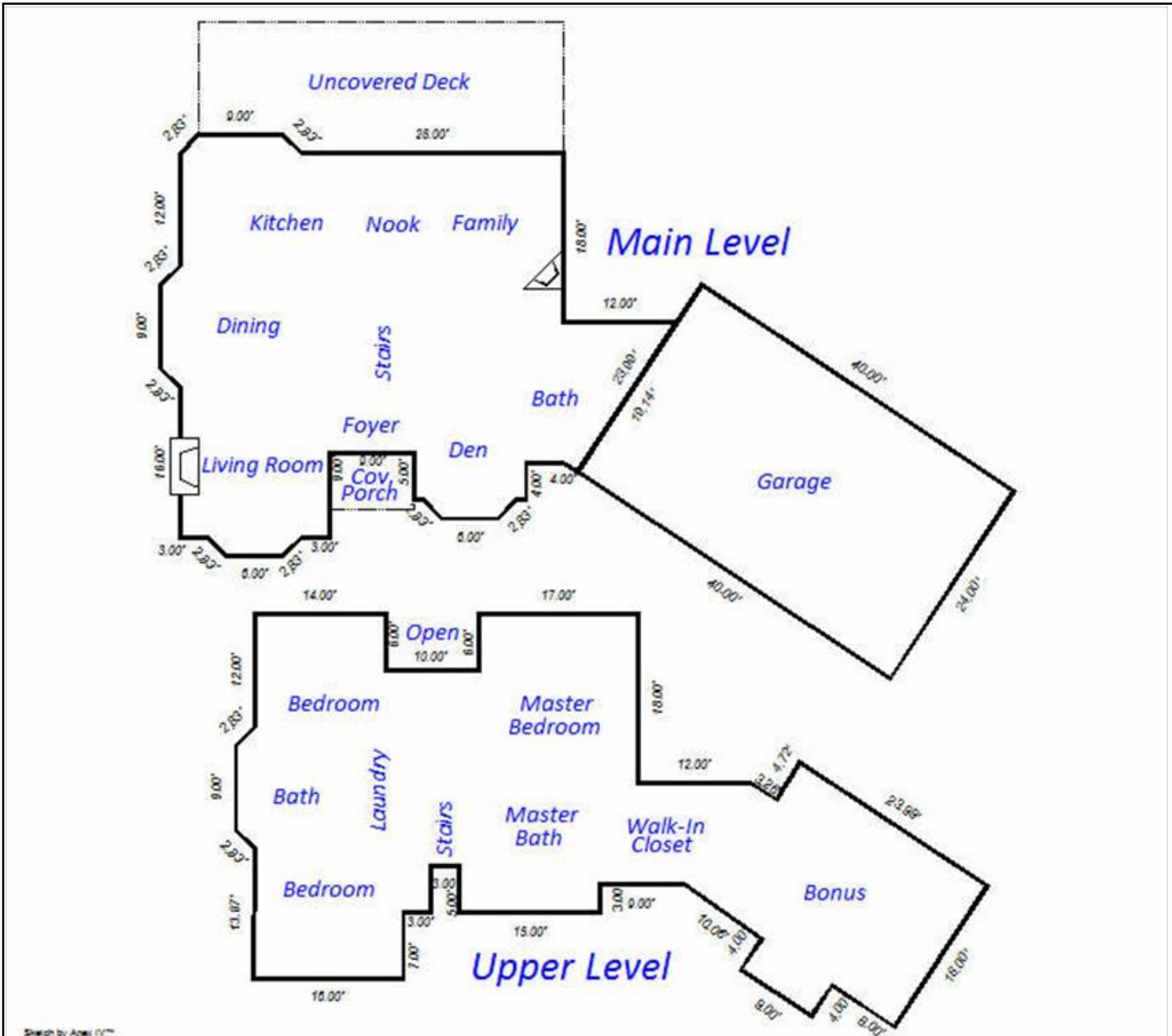

Sketch by Apex IV™

Comments:

AREA CALCULATIONS SUMMARY			
Code	Description	Size	Net Totals
GLA1	First Floor	1703.2500	1703.2500
GLA2	Second Floor	1952.3481	1952.3481
P/P	Covered Porch	54.0000	
	Uncovered Deck	526.0000	580.0000
GAR	Garage	959.8173	959.8173
TOTAL LIVABLE		(rounded)	3656

LIVING AREA BREAKDOWN			
Breakdown			Subtotals
First Floor			
0.5 x	2.00 x	2.00	2.0000
0.5 x	2.00 x	2.00	2.0000
	2.00 x	13.00	26.0000
	2.00 x	9.00	18.0000
0.5 x	2.00 x	2.00	2.0000
0.5 x	2.00 x	2.00	2.0000
	2.00 x	12.00	24.0000
	2.00 x	16.00	32.0000
	3.00 x	43.00	129.0000
	6.00 x	45.00	270.0000
	11.00 x	37.00	407.0000
	2.00 x	6.00	12.0000
0.5 x	2.00 x	2.00	2.0000
0.5 x	2.00 x	2.00	2.0000
	12.00 x	32.00	384.0000
72 unlisted calculations			2341.5981
87 Calculations Total (rounded)			3656